

# WINCORE<sup>TM</sup>

## WINDOWS & DOORS

250 Staunton Turnpike, Parkersburg, WV 26104

### 8800 Series Vinyl Fixed Window "IMPACT"

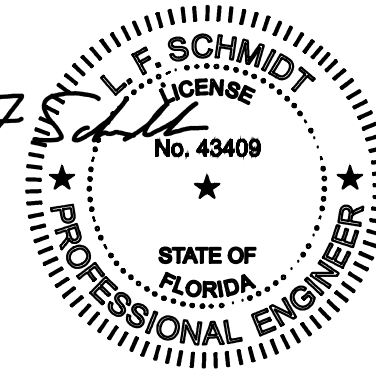
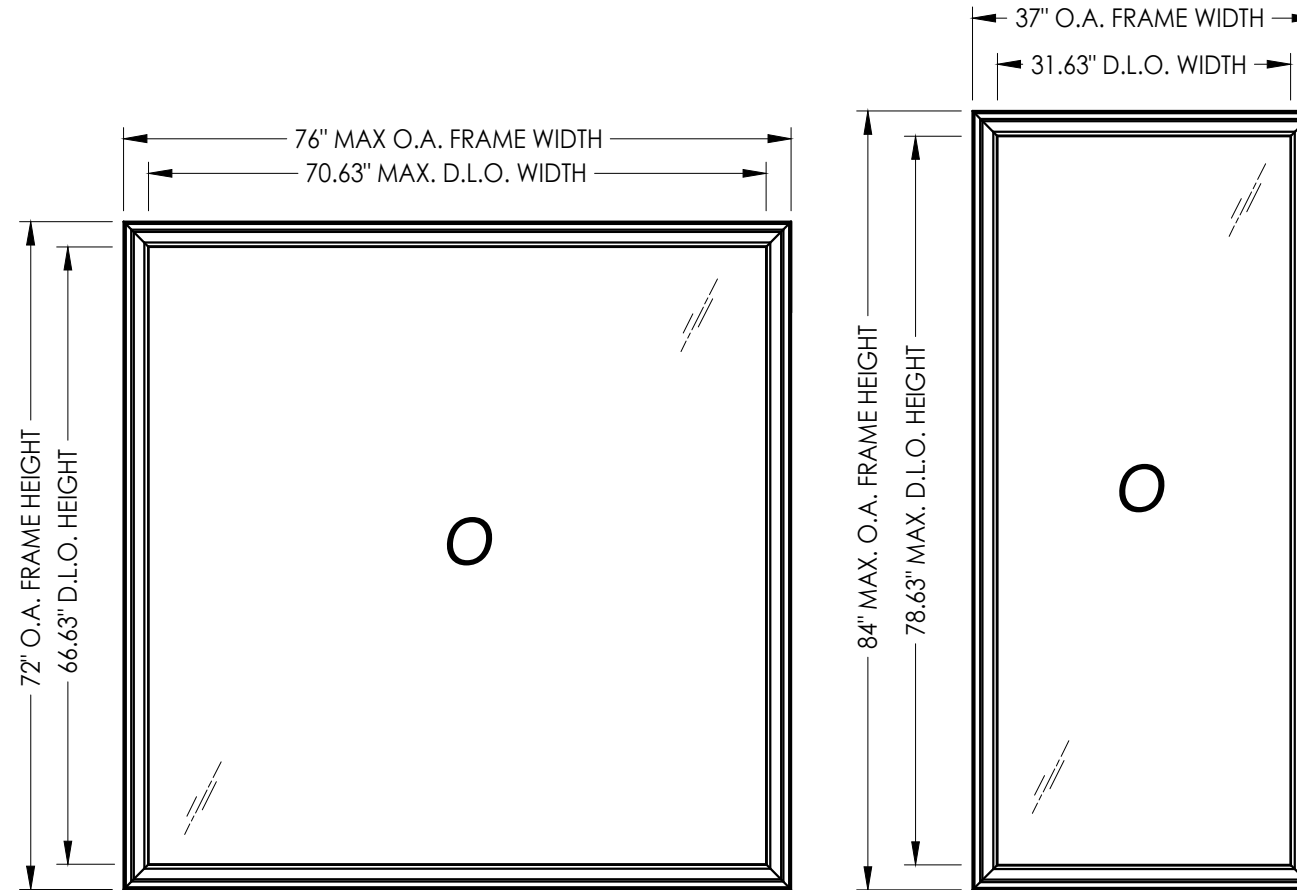

This item has been digitally signed and sealed by L. F. Schmidt, P.E. on the date adjacent to the seal. Printed copies of this document are not considered signed and sealed and the signature must be verified on any electronic copies.

THIS PRODUCT APPROVAL IS VALID ONLY FOR THE STATE OF FLORIDA

Documents Prepared By:  
 Lyndon F. Schmidt  
 P.E. No. 43409

*R.W.* BUILDING CONSULTANTS, INC.  
 P.O. Box 230, Valrico, FL 33595  
 Phone No.: 813.659.9197  
 FBPE Registry No. 9813

#### GENERAL NOTES

- This product has been evaluated and is in compliance with the 8th Edition (2023) Florida Building Code (FBC) structural requirements excluding the "High Velocity Hurricane Zone" (HVHZ).
- Product anchors shall be as listed and spaced as shown on details. Anchor embedment to base material shall be beyond wall dressing or stucco.
- When used in areas requiring wind borne debris protection this product complies with FBC Sections 1609.1.2 & R301.2.1.2 and does not require an impact resistant covering. This product meets missile level "D" and includes Wind Zone 4 as defined in ASTM E1996 and FBC Sections 1609.1.2.2 & R301.2.1.2.1. Exception: Glazing Detail (G7) excludes Wind Zone 4 as defined in ASTM E 1996.
- For 2x stud framing construction, anchoring of these units shall be the same as that shown for 2x buck masonry construction.
- Site conditions that deviate from the details of this drawing require further engineering analysis by a licensed engineer or registered architect.

TABLE OF CONTENTS	
SHEET#	DESCRIPTION
1	Typical elevations, design pressures and general notes
2	Horizontal cross sections
3	Buck anchoring
4	Frame anchoring
5	Bill of materials, components and glazing details

MAX. FRAME DIMENSION	MAX. D.L.O. DIMENSION	GLASS TYPE	DESIGN PRESSURE (PSF)	
			POSITIVE	NEGATIVE
37.0" X 84.0"	31.63" X 78.63"	G1	+65.0	-65.0
		G5	+50.0	-50.0
48.0" X 60.0"	42.63" X 54.63"	G2, G5	+50.0	-50.0
54.0" X 84.0"	42.63" X 54.63"	G7*	+50.0	-50.0
64.0" X 64.0"	58.63" X 58.63"	G1	+60.0	-60.0
		G6	+50.0	-50.0
72.0" X 72.0"	66.63" X 66.63"	G3	+65.0	-65.0
		G4	+50.0	-50.0
76.0" X 63.0"	70.63" X 57.63"	G3	+65.0	-70.0

\*Glazing Detail (G7) excludes Wind Zone 4 as defined in ASTM E 1996.  
 NOTE: Maximum frame width and height occur on separate units.

PRODUCT:  
 8800 SERIES  
 VINYL FIXED WINDOW

PART OR ASSEMBLY:  
 TYPICAL ELEVATION, DESIGN PRESSURES & GENERAL NOTES

NO.	DATE	BY	REVISIONS
7	7/06/23	LFS	UPDATE TO 8TH ED. (2023) FBC
6	7/06/20	LFS	UPDATE TO 7TH ED. (2020) FBC
5	6/01/17	LFS	UPDATE TO 6TH ED. (2017) FBC
4	9/20/16	LFS	ADD NEW FRAME SIZE/GLZ DETAIL

DATE: 8/2/12  
 SCALE: N.T.S.  
 DWG. BY: JK  
 CHK. BY: LFS  
 DRAWING NO.: FL-15816.2  
 SHEET 1 OF 5

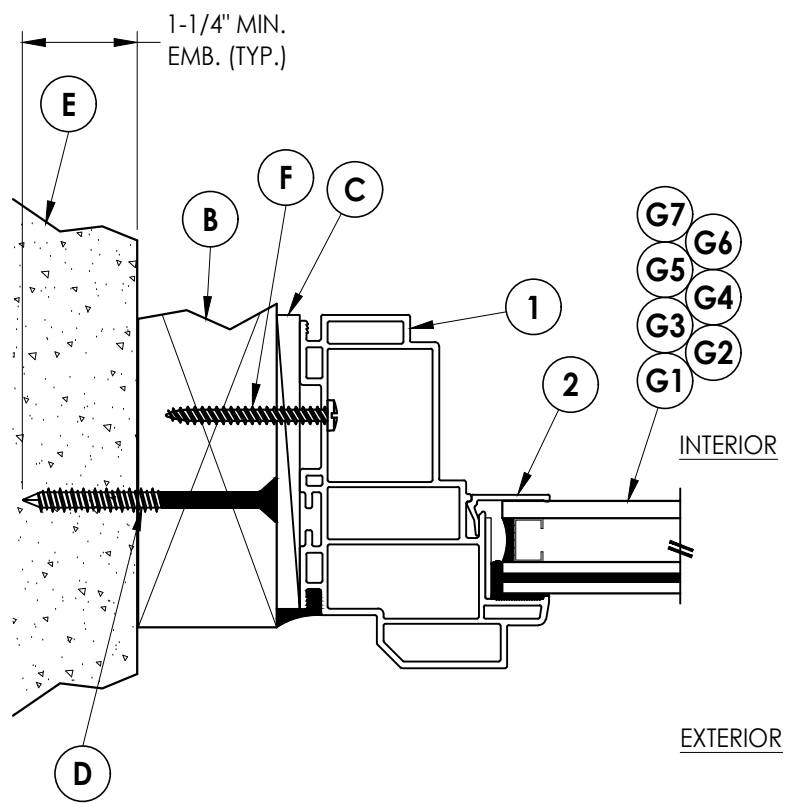

**1 HORIZONTAL CROSS SECTION**  
**2** Shown w/ 2X buck

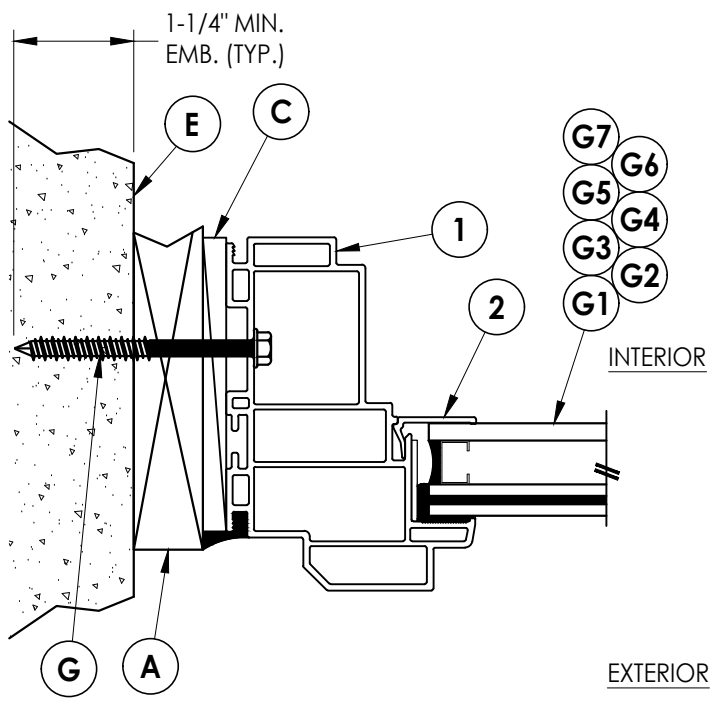
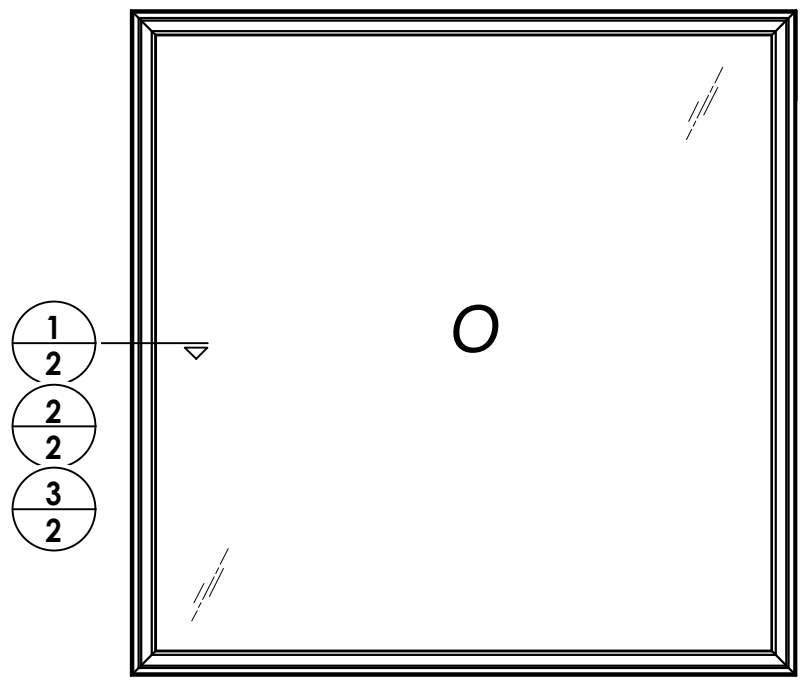

**2 HORIZONTAL CROSS SECTION**  
**2** Shown w/ 1X buck

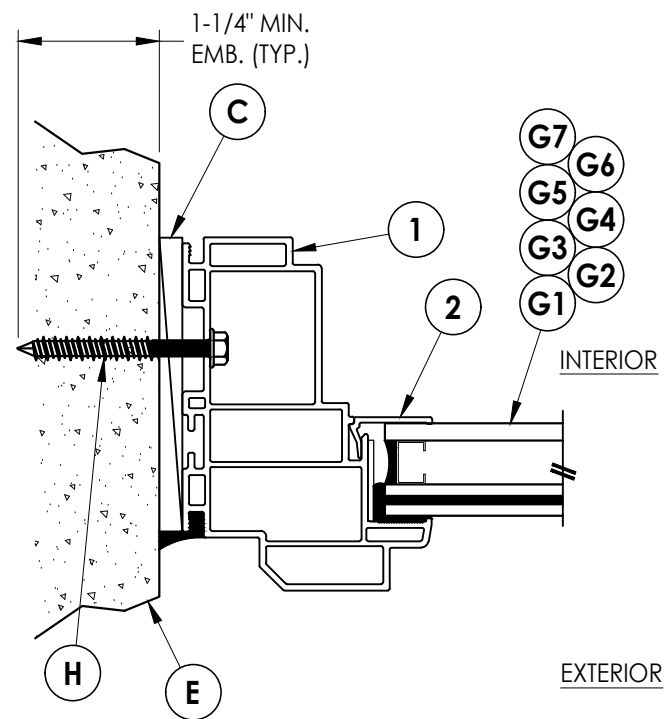

**3 HORIZONTAL CROSS SECTION**  
**2** Shown direct to masonry

Documents Prepared By: Lyndon F. Schmidt P.E. No. 43409		BUILDING CONSULTANTS, INC. P.O. Box 230, Vairico, FL 33595 Phone No.: 813.659.9197 FBPE Registry No. 9813		
PRODUCT: 8800 SERIES VINYL FIXED WINDOW		PART OR ASSEMBLY: HORIZONTAL CROSS SECTIONS		
7	7/06/23	UPDATE TO 8TH ED. (2023)	FBC	LFS
6	7/06/20	UPDATE TO 7TH ED. (2020)	FBC	LFS
5	6/01/17	UPDATE TO 6TH ED. (2017)	FBC	LFS
4	9/20/16	ADD NEW FRAME SIZE/GLZ DETAIL	LFS	BY
	NO.	DATE		
				REVISIONS
DATE: 8/2/12				
SCALE: N.T.S.				
DWG. BY: JK				
CHK. BY: LFS				
DRAWING NO.: FL-15816.2				
SHEET 2 OF 5				

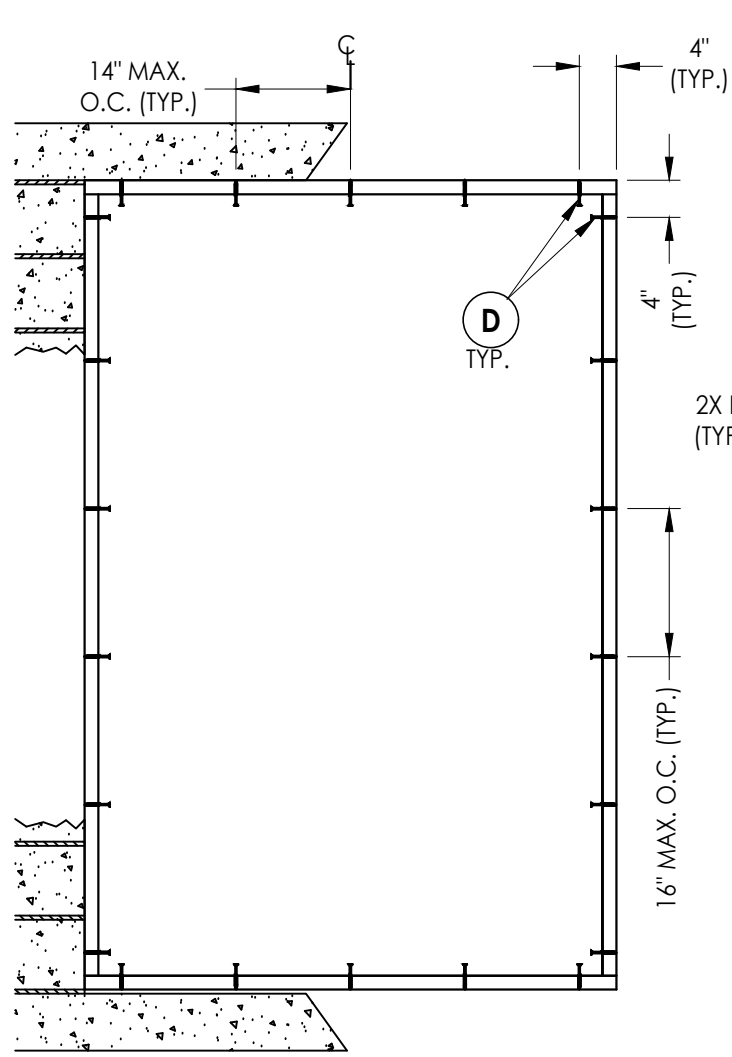

**BUCK ANCHORING**  
 37" X 84" MAX (DP ≤ 65 PSF)  
 54" X 84" MAX (DP ≤ 50 PSF)

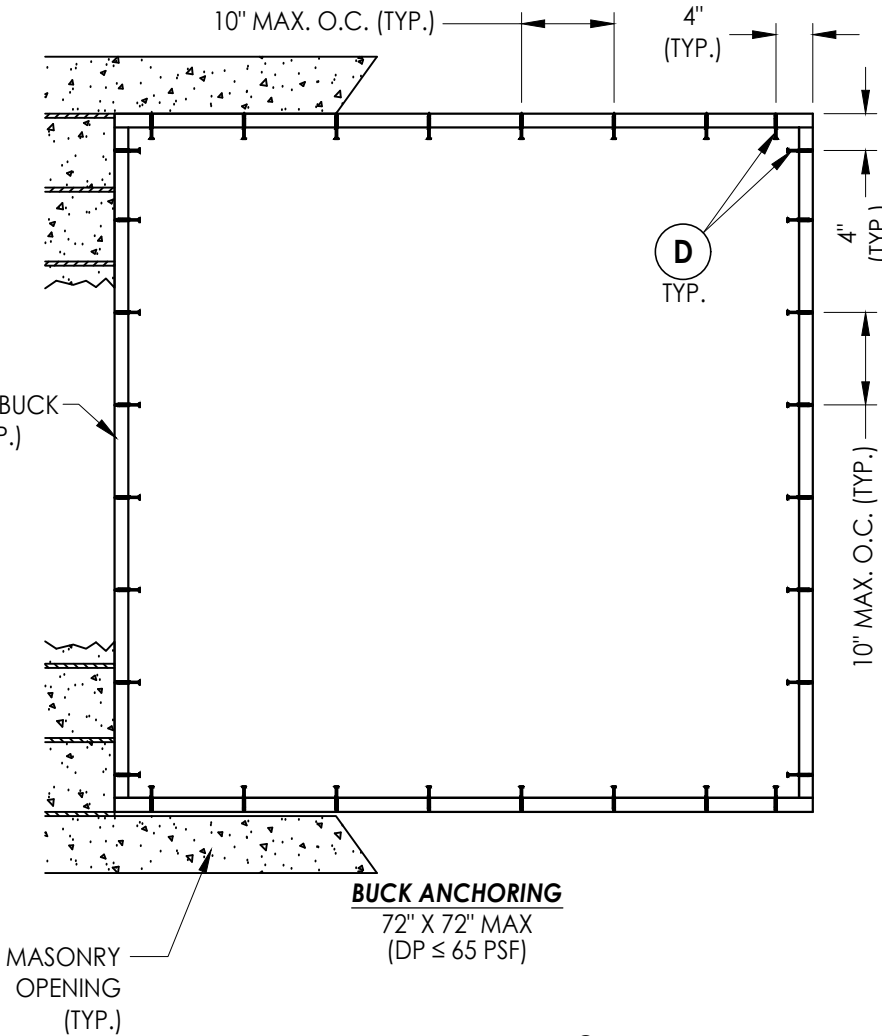

**BUCK ANCHORING**  
 72" X 72" MAX  
 (DP ≤ 65 PSF)

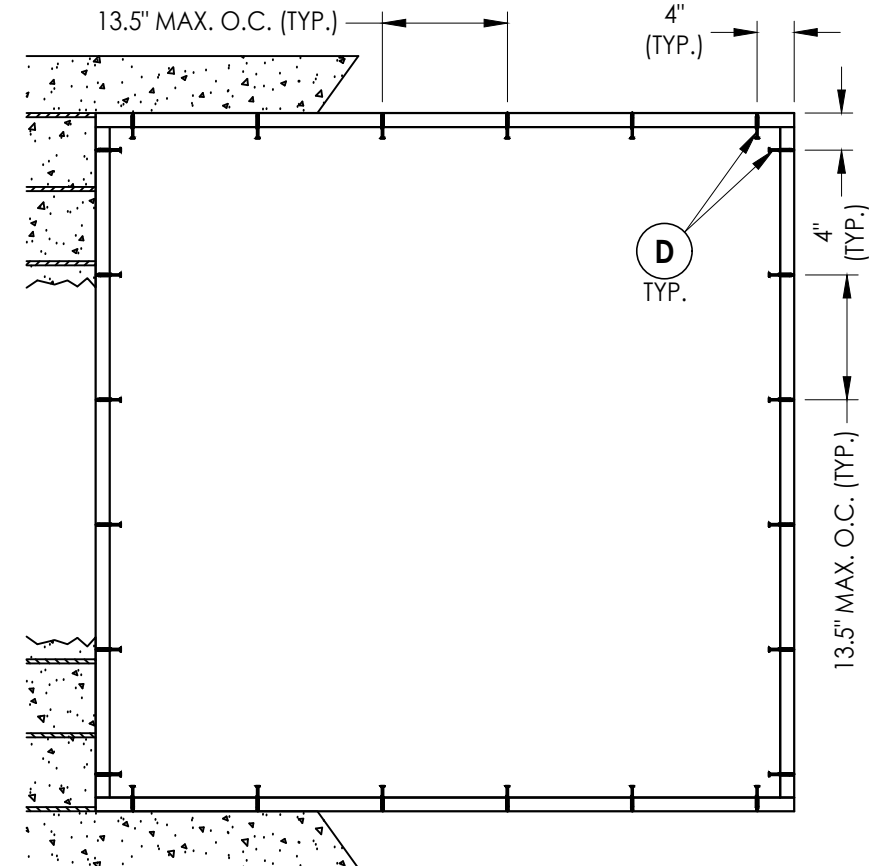

**BUCK ANCHORING**  
 72" X 72" MAX  
 (DP ≤ 50 PSF)

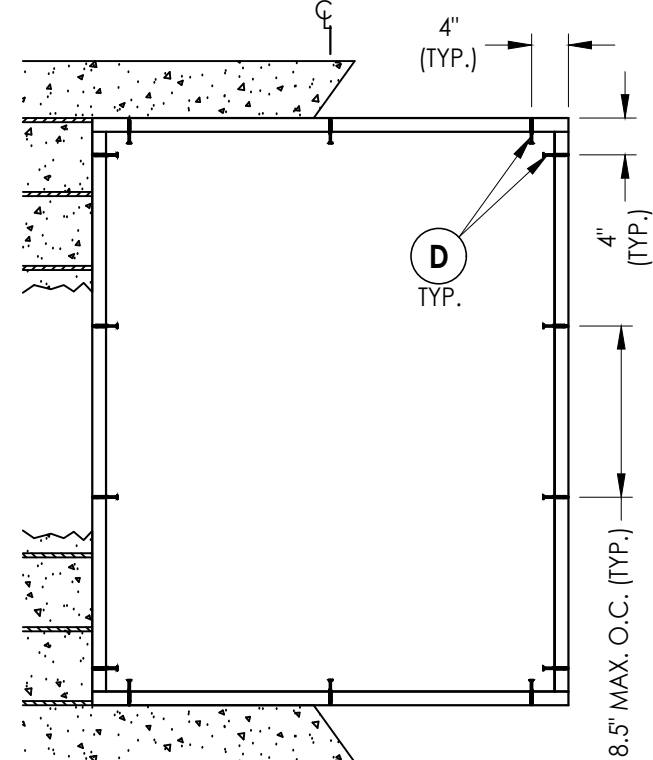

**BUCK ANCHORING**  
 48" X 60" MAX  
 (DP ≤ 50 PSF)

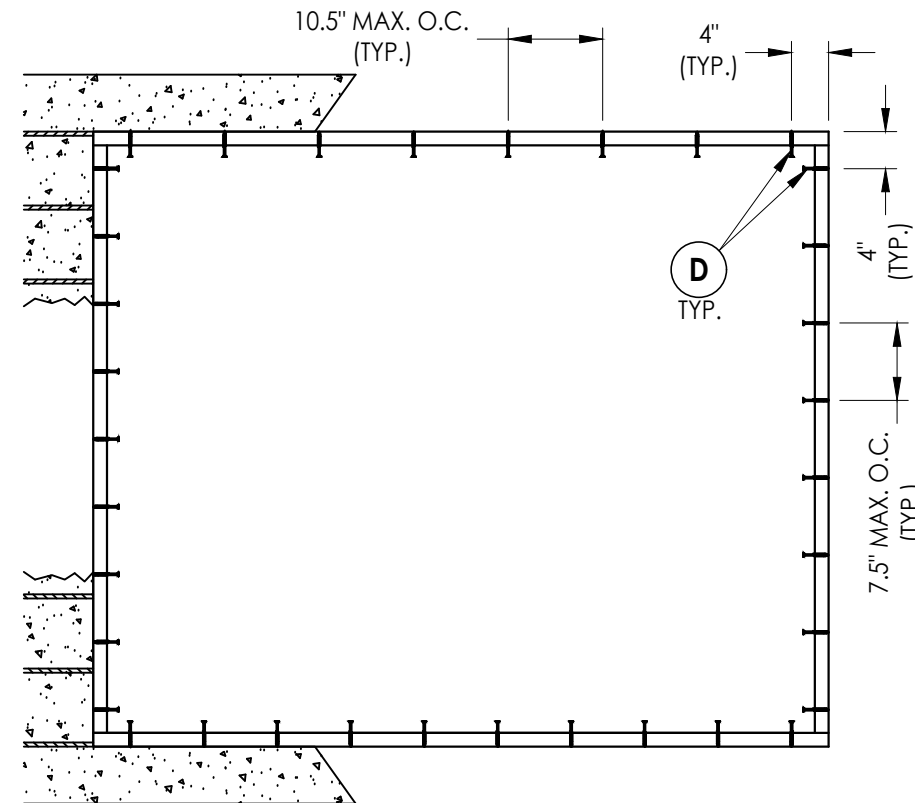

**BUCK ANCHORING**  
 76" X 63" MAX  
 (DP ≤ 70 PSF)

**CONCRETE ANCHOR NOTES:**

1. Concrete anchor locations at the corners may be adjusted to maintain the min. edge distance to mortar joints.
2. Concrete anchor locations noted as "MAX. ON CENTER" must be adjusted to maintain the min. edge distance to mortar joints, additional concrete anchors may be required to ensure the "MAX. ON CENTER" dimension are not exceeded.
3. Concrete anchor table:

ANCHOR TYPE	ANCHOR SIZE	MIN. EMBEDMENT	MIN. CLEARANCE TO MASONRY EDGE	MIN. CLEARANCE TO ADJACENT ANCHOR
ITW TAPCON®	1/4"	1-1/4"	2"	4"
DeWALT ULTRACON+®	1/4"	1-1/4"	1"	4"

**WOOD SCREW INSTALLATION NOTES:**

1. Maintain a minimum 5/8" edge distance, 1" end distance, & 1" o.c. spacing of wood screws to prevent the splitting of wood.

Documents Prepared By:  
 Lyndon F. Schmidt  
 P.E. No. 43409

**RW** BUILDING CONSULTANTS, INC.  
 P.O. Box 230, Vairico, FL 33595  
 Phone No.: 813.659.9197  
 FBPE Registry No. 9813

PRODUCT:  
 8800 SERIES  
 VINYL FIXED WINDOW

PART OR ASSEMBLY:  
 BUCK ANCHORING

NO.	DATE	REVISIONS
7	7/06/23	UPDATE TO 8TH ED. (2023) FBC LFS
6	7/06/20	UPDATE TO 7TH ED. (2020) FBC LFS
5	6/01/17	UPDATE TO 6TH ED. (2017) FBC LFS
4	9/20/16	ADD NEW FRAME SIZE/GLZ DETAIL LFS
		BY

DATE: 8/2/12

SCALE: N.T.S.

DWG. BY: JK

CHK. BY: LFS

DRAWING NO.: FL-15816.2

SHEET 3 of 5

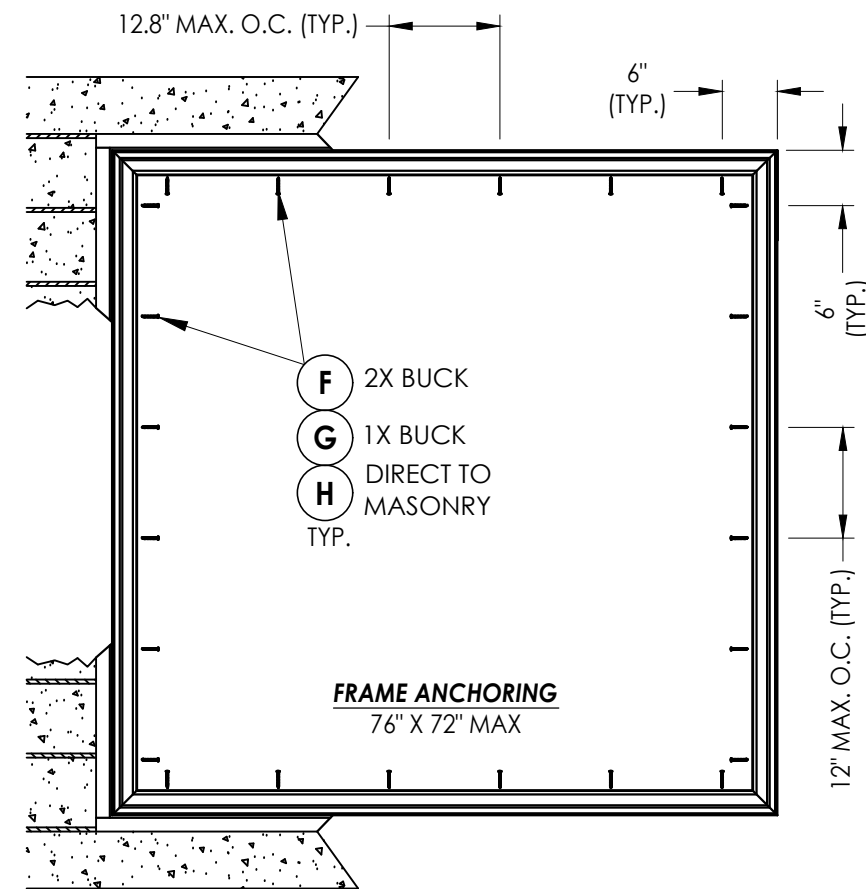
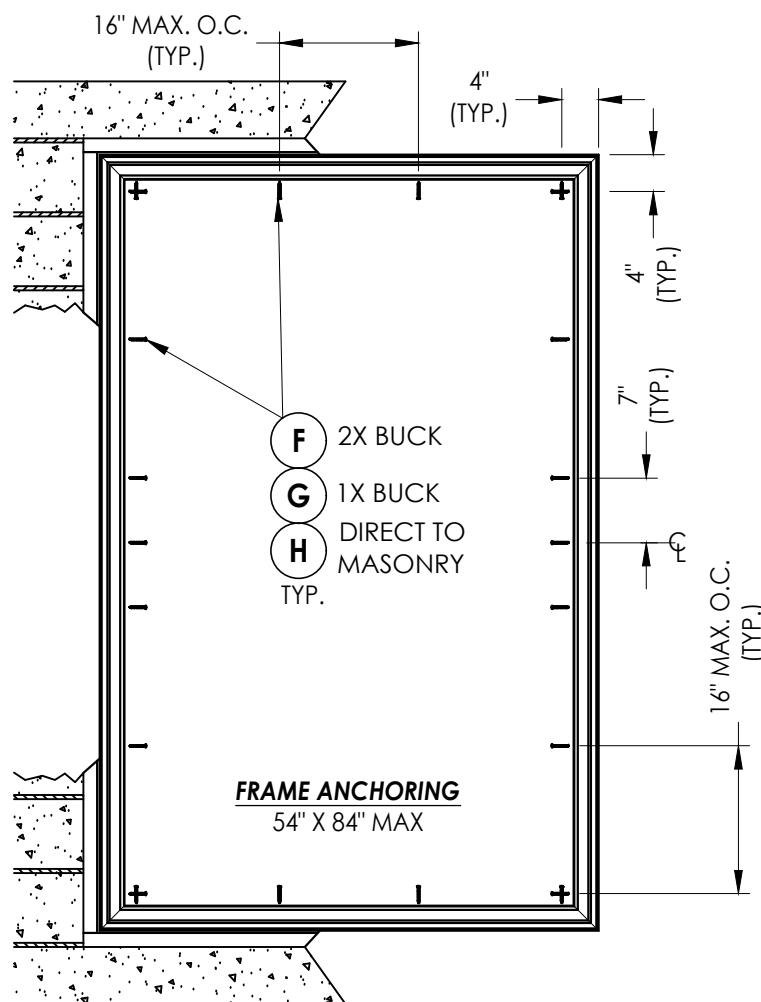
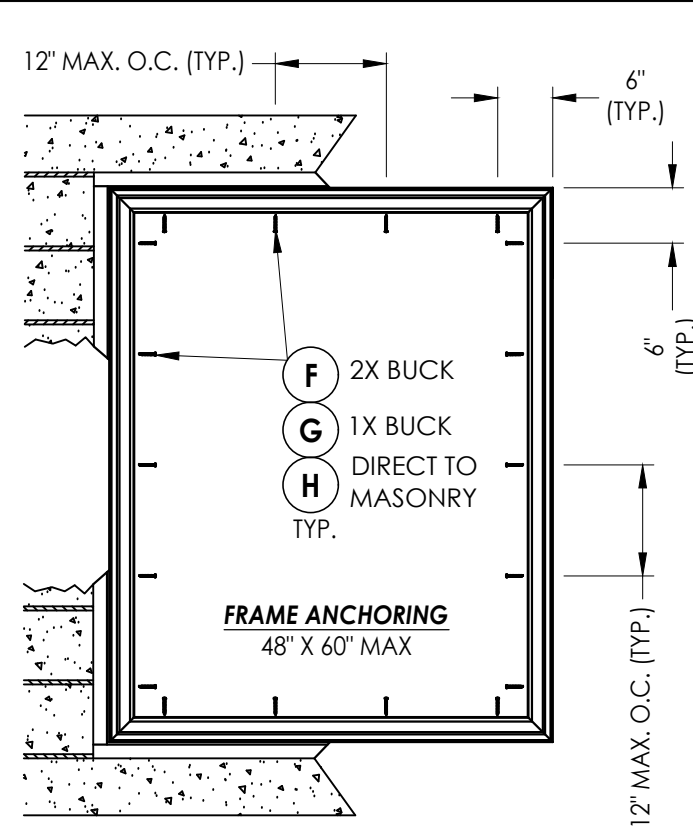
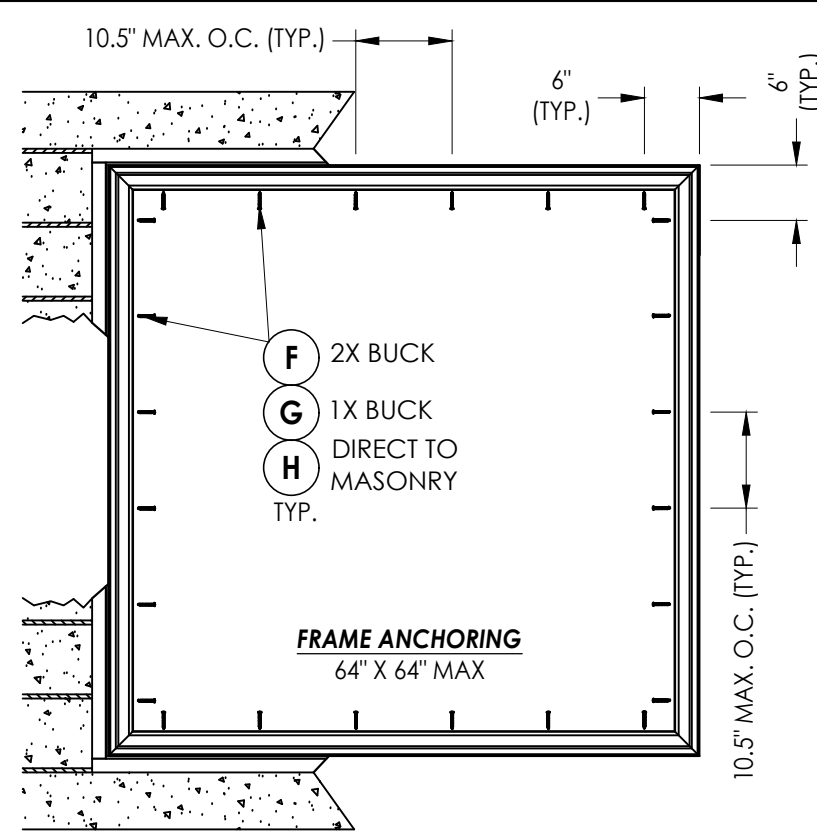
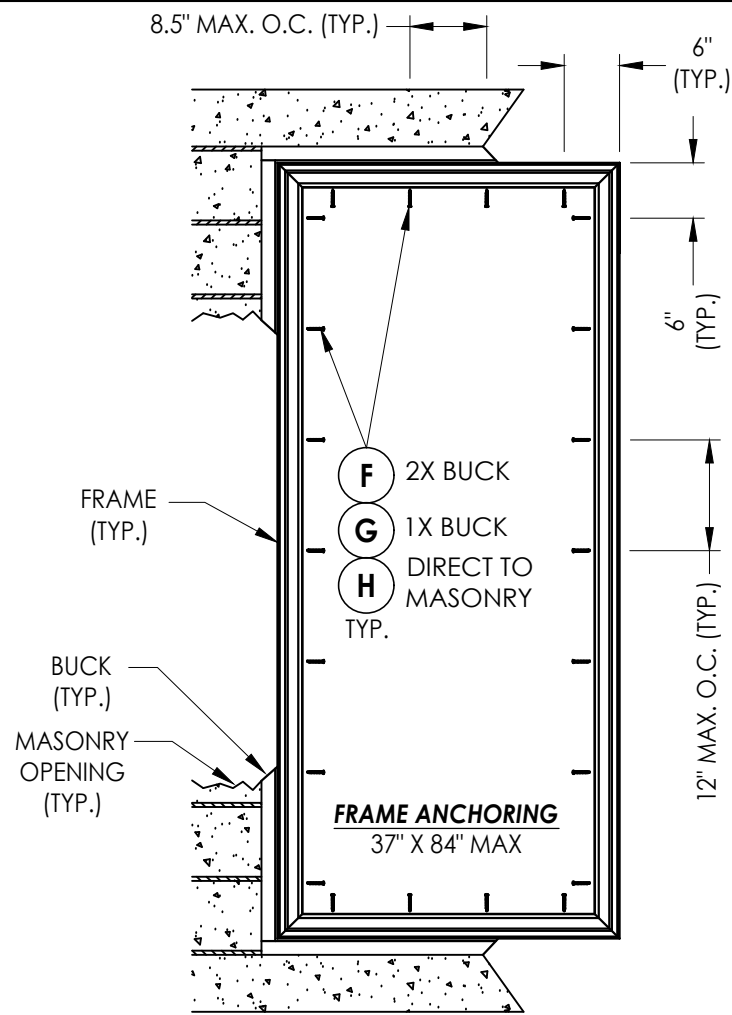

**CONCRETE ANCHOR NOTES:**

1. Concrete anchor locations at the corners may be adjusted to maintain the min. edge distance to mortar joints.
2. Concrete anchor locations noted as "MAX. ON CENTER" must be adjusted to maintain the min. edge distance to mortar joints, additional concrete anchors may be required to ensure the "MAX. ON CENTER" dimension are not exceeded.
3. Concrete anchor table:

ANCHOR TYPE	ANCHOR SIZE	MIN. EMBEDMENT	MIN. CLEARANCE TO MASONRY EDGE	MIN. CLEARANCE TO ADJACENT ANCHOR
ITW TAPCON®	1/4"	1-1/4"	2"	4"
DeWALT ULTRACON®	1/4"	1-1/4"	1"	4"

**WOOD SCREW INSTALLATION NOTES:**

1. Maintain a minimum 5/8" edge distance, 1" end distance, & 1" o.c. spacing of wood screws to prevent the splitting of wood.

Documents Prepared By:  
Lyndon F. Schmidt  
P.E. No. 43409

**RW** BUILDING CONSULTANTS, INC.  
P.O. Box 230, Valrico, FL 33595  
Phone No.: 813.659.9197  
FBPE Registry No. 9813

PRODUCT:  
8800 SERIES  
VINYL FIXED WINDOW

PART OR ASSEMBLY:  
FRAME ANCHORING

NO.	DATE	REVISIONS
7	7/06/23	UPDATE TO 8TH ED. (2023) FBC LFS
6	7/06/20	UPDATE TO 7TH ED. (2020) FBC LFS
5	6/01/17	UPDATE TO 6TH ED. (2017) FBC LFS
4	9/20/16	ADD NEW FRAME SIZE/GLZ DETAIL LFS

DATE: 8/2/12

SCALE: N.T.S.

DWG. BY: JK

CHK. BY: LFS

DRAWING NO.:

FL-15816.2

SHEET 4 OF 5

BILL OF MATERIALS		
ITEM #	DESCRIPTION	MATERIAL
A	1X BUCK (SG >= 0.42)	WOOD
B	2X BUCK (SG >= 0.42)	WOOD
C	1/4" MAX. SHIM SPACE	-
D	1/4" X 2-3/4" PFH DeWALT OR ITW CONCRETE SCREW	STEEL
E	MASONRY - 3,000 PSI MIN. CONCRETE CONFORMING TO ACI 301 OR HOLLOW BLOCK CONFORMING TO ASTM C90	CONCRETE
F	#10 X 1-3/4" PPH WOOD SCREW (1-3/16" MIN. EMBEDMENT)	STEEL
G	1/4" X 2-3/4" HWH DeWALT OR ITW CONCRETE SCREW	STEEL
H	1/4" X 2-1/4" HWH DeWALT OR ITW CONCRETE SCREW	STEEL
1	FRAME (PI7701WH)*	PVC
2	1" GLAZING BEAD (BV56WH)*	PVC

\* THE APPROVED WHITE RIGID PVC EXTERIOR EXTRUSIONS FOR WINDOWS ARE TO BE PRODUCED BY EXTRUDERS LICENSEES IN "AAMA CERTIFICATION PROGRAMS FOR RIGID PVC EXTRUSIONS".

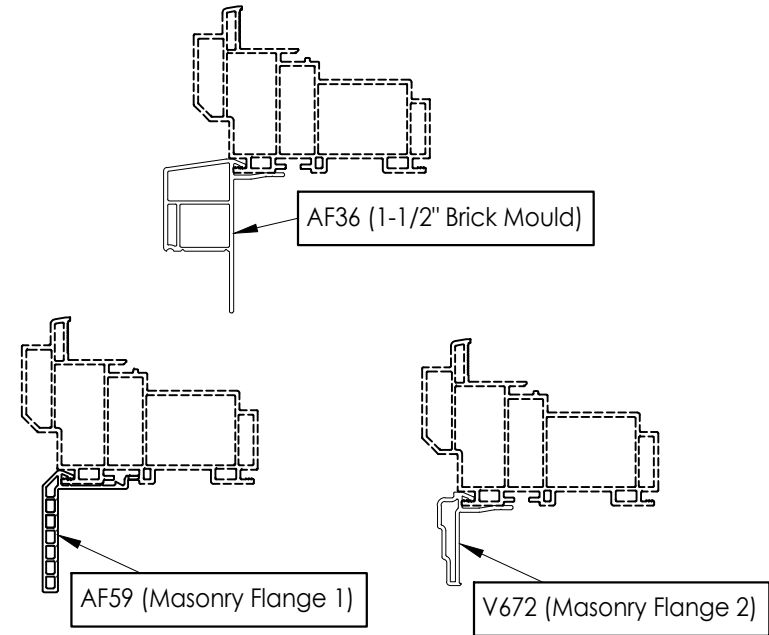
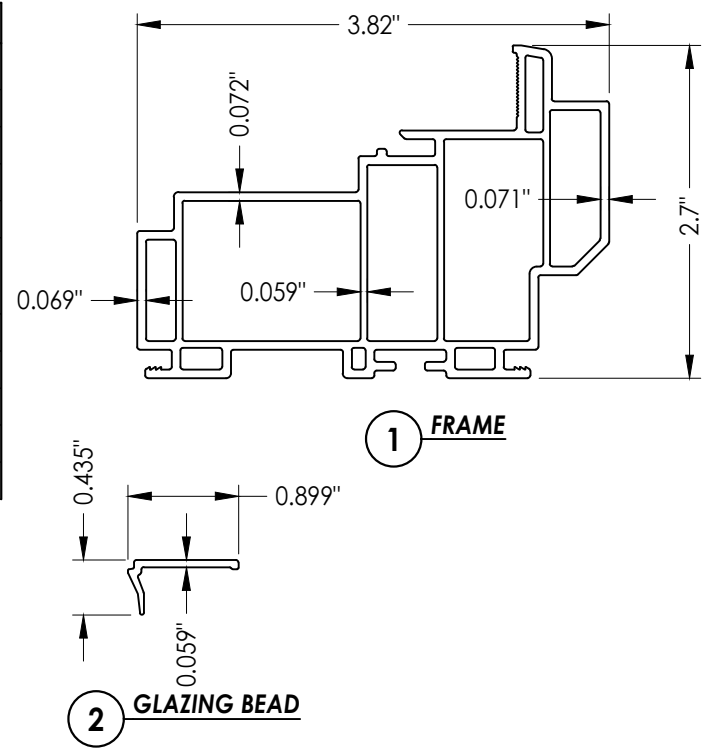

**OPTIONAL COSMETIC FLANGES**

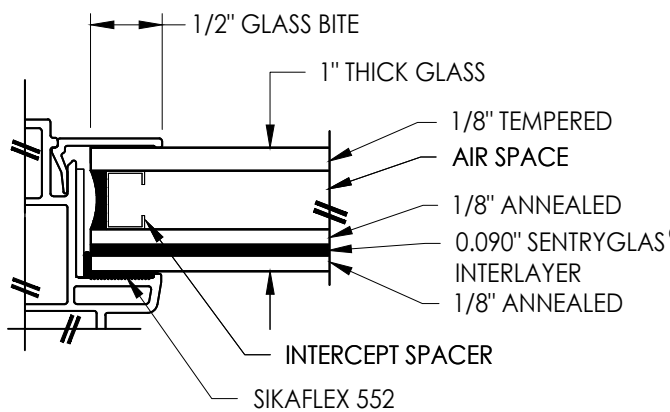

**G1 GLAZING DETAIL**

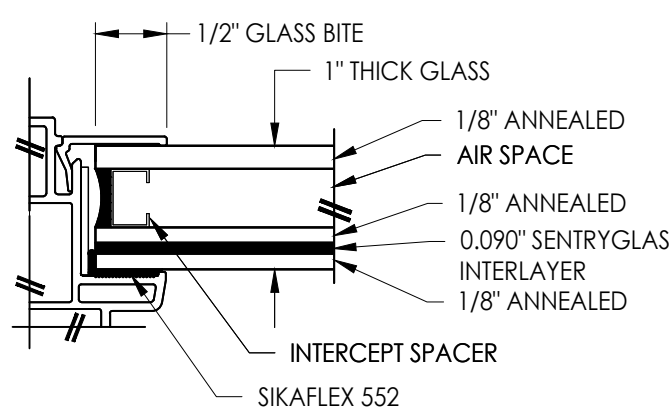

**G2 GLAZING DETAIL**

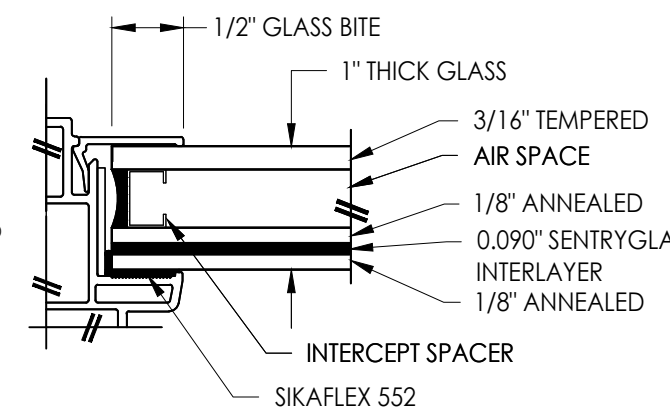

**G3 GLAZING DETAIL**

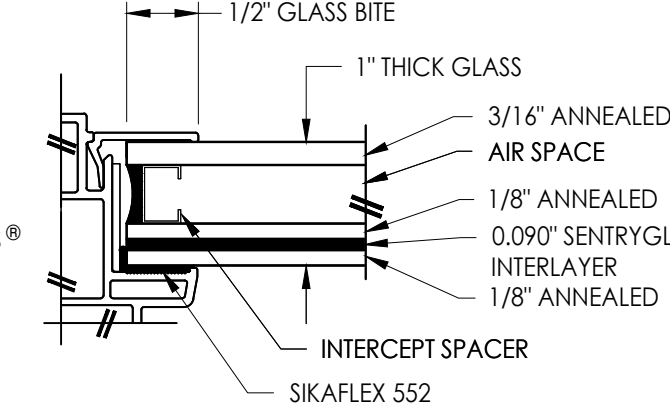

**G4 GLAZING DETAIL**

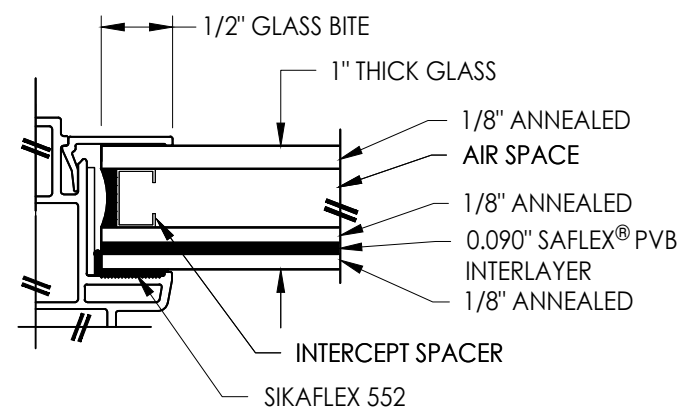

**G5 GLAZING DETAIL**

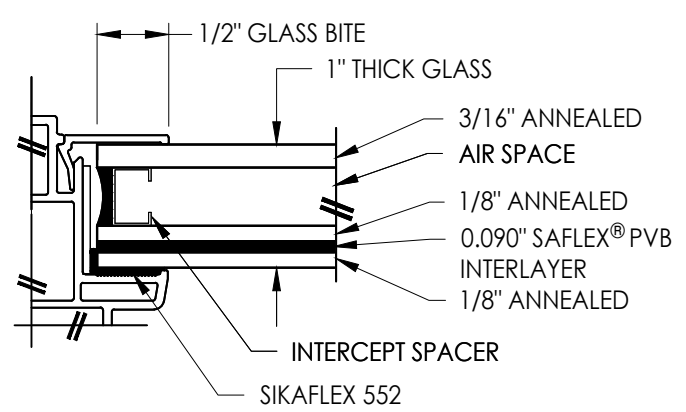

**G6 GLAZING DETAIL**

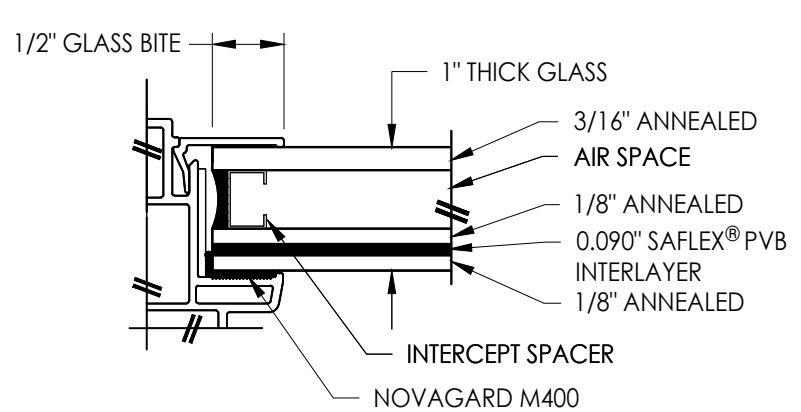

**G7 GLAZING DETAIL**

Documents Prepared By: Lyndon F. Schmidt P.E. No. 43409		BUILDING CONSULTANTS, INC. P.O. Box 230, Valrico, FL 33595 Phone No.: 813.659.9197 FBPE Registry No. 9813	
PRODUCT:	8800 SERIES VINYL FIXED WINDOW	PART OR ASSEMBLY:	BILL OF MATERIALS, COMPONENTS AND GLAZING DETAILS
	UPDATE TO 8TH ED. (2023) FBC LFS		
	UPDATE TO 7TH ED. (2020) FBC LFS		
	UPDATE TO 6TH ED. (2017) FBC LFS		
	ADD NEW FRAME SIZE/GLZ DETAIL		
	NO. DATE		
			REVISIONS
DATE:	8/2/12		
SCALE:	N.T.S.		
DWG. BY:	JK		
CHK. BY:	LFS		
DRAWING NO.:	FL-15816.2		
SHEET	5	OF	5